

Virutex AB111N Biscuit Jointer-



The Virutex AB111N Biscuit Jointer is specially designed for grooving panels in any position, featuring a micrometric fence which can be adjusted at any height and angle.

A pre-adjusted stop allows you to select the different grooving depths quickly and easily. The machine is typically used on panels of 16, 19 and 22mm thickness, but it is possible to work on thicker pieces, thanks to the movable fence.

The AB111N is equipped with a 900W motor with constant torque control for a constant motor speed under load.

Auckland
19 Allens Road, East Tamaki
Auckland 2013
Ph (09) 271 7700
Fax (09) 271 7728

Christchurch
159 Ferry Road, Waltham
Christchurch 8011
Ph (03) 366 2013
Fax (03) 366 2021

Call free: 0800 522 577
Copyright © 2025 W & R Jack Limited.



Virutex AB111N Biscuit Jointer-



Angle and height-adjustable front fence with graded scale



Quick adjustment of different grooving depths

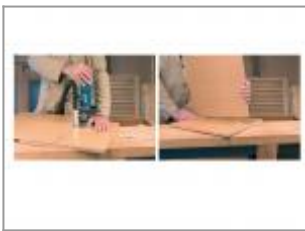

Joints in the middle of the board

Overview and features

Specifications

Motor	900W (1.2hp)
Max. saw blade Ø	10,000rpm
Blade	100 x 22 x 4mm
Maximum cutting depth	20mm slot

Specifications are subject to change without notice.

Auckland
19 Allens Road, East Tamaki
Auckland 2013
Ph (09) 271 7700
Fax (09) 271 7728

Christchurch
159 Ferry Road, Waltham
Christchurch 8011
Ph (03) 366 2013
Fax (03) 366 2021

Call free: 0800 522 577
Copyright © 2025 W & R Jack Limited.

